

1 2 3 4 5 6 7 8

REV	MODIFICATION	DATE	DRAW

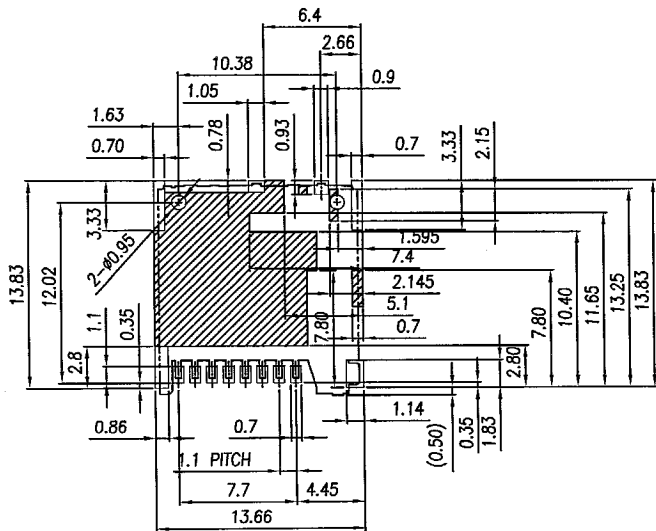

P.C.B Layout (Top View)

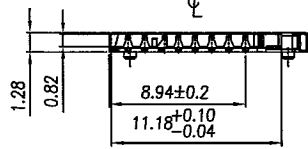
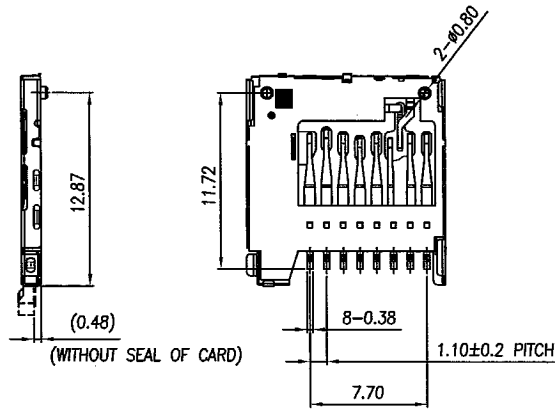
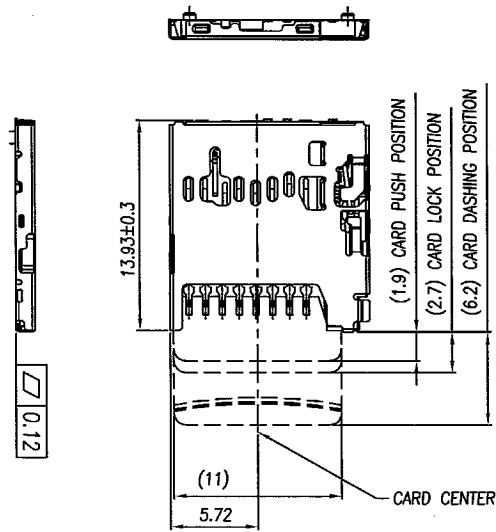
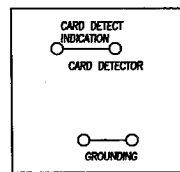
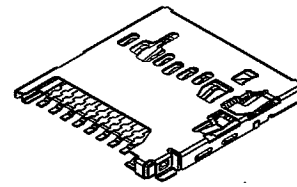

WITHOUT CARD

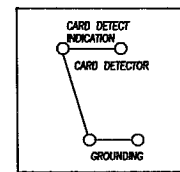

CARD INSERTED



NOTES:

- General Characteristics
Mounting System:SMT
- Material and Finish:
Insulation material:High Temperature Plastic (UL94V-0)
Contact material:Copper Alloy
Contact Finish:See Order Information Selectivity.
- Electrical Characteristics
Contact resistance: Contact: Initial value : 100 mΩ Max.
Insulation resistance:>1000 mega ohms /500V DC
Withstanding Voltage: 500V AC (rms) for 1minute
Operation:Normally open.
- Environmental Characteristics
Operating temperature:-25°C~+85°C
- ORDER INFORMATION:
TFJMF-108 01 BTO 1

Package:
1 : TAPE REEL

Contact Area Plating:
01 : Gold Flash Plating.

T-FLASH		DIMENSION IN mm [Inch]		PROD. SPEC.	KINGFONT PRECISION INDUSTRIAL CO., LTD.	
PIN	NAME	TOLERANCE UNLESS OTHERWISE SPECIFIED		SP0137	TITLE MICRO SD CONN. PUSH/PUSH NORMAL SUPER-SMALL TYPE CUSTOMER DRAWING	
1	DAT2			PKG. SPEC.	FILE NO. KFP-137 DWG NO.TFJMF-10801BTO1	
2	CD/DAT3			PPP-TFC-001	PROJ. SHEET 1 / 1	
3	CMD	.X±0.30	X'±	APPROVE <i>Gant</i>	SCALE 2:1 REV A	
4	VDD			CHECK <i>JH</i>	SIZE A4	
5	CLK	.XX±0.20	.X'±	DRAW <i>Jong</i>	8 QR-2100-043	
6	VSS2					
7	DAT0	.XXX±0.10	.XX'±			
8	DAT1					