

SPIROL[®]

PIN INSTALLATION TECHNOLOGY

Model PM Manual Pin Inserter

This exceptionally versatile tool is ideally suited to all levels of production: from a single unit for prototype assembly, to multiple units on an assembly line. The **Model PM** easily accommodates quick change-overs. The part holding device (fixture) is simply replaced from the base of the machine. The pin diameter is easily changed, positive pin depth easily adjusted, and part size variation easily accommodated. The use of high-tech shafting and bearings results in smooth operation, precise positioning, repeatability, and durability.

Design Features/Benefits:

- Easy:** - Simple to operate and easily adjustable
- Accurate:** - Base plate is pre-drilled for simple and precise fixture location
- Reliable:** - Post mount style frame is sturdy, lightweight and portable
- Versatile:** - Installs pins ranging in diameter from 0.8 mm to 4 mm, and 1/32" to 5/32" unified
 - Easy tooling changeover to accommodate a variety of applications
- Capacities:** - 200 lbs. maximum insertion force
 - Vertical adjustment: 0-178 mm (7")
 - Fixed throat dimension: 185 mm (7.5")
 - Stroke: 76 mm (3")

Simple Operation:

1. Load the part to be pinned into an alignment fixture
2. Manually insert a pin into the spring-loaded jaws of the pin-driving chuck
3. Pull the lever until the unit reaches a finely adjustable pre-set stop
4. Release the lever
5. Unload the finished assembly

Optional alignment fixtures available.

Automatic and Semi-Automatic machines are also available from SPIROL.



Shown with optional fixture

Easily accommodates all **SPIROL Pin-Driving Chucks:** SPD-101, CXA, CXD



See the **Model PM** in action:
<https://youtu.be/k9XDIdn1FBE>



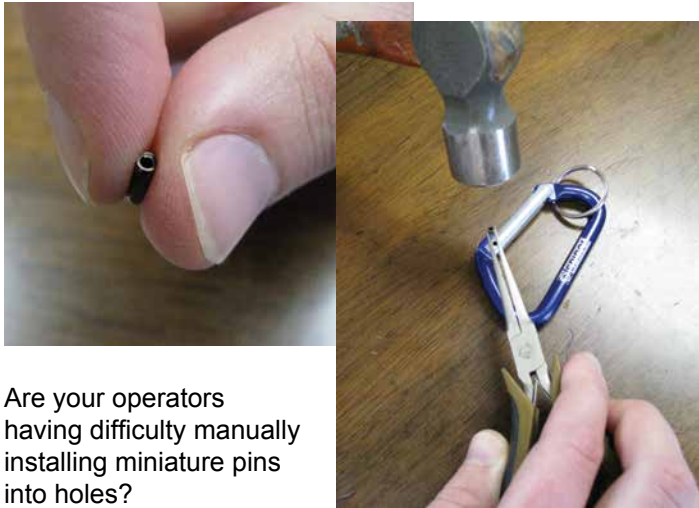

Are your operators having difficulty manually installing miniature pins into holes?

Are you experiencing an unacceptable percentage of damaged parts or other quality issues resulting from the installation process?

A significant advantage of the **SPIROL Model PM Manual Pin Inserter** is that it delivers the pin to the installation site with precise positioning, repeatability, and smooth operation without the operator having to struggle to hold the pin during installation.

Operators manually insert a pin into the spring-loaded jaws of the pin-driving chuck and pull the lever until the unit reaches a finely adjustable pre-set stop.

For very small pins, please consider the use of a SPIROL PR machine to eliminate the need for the operator to handle the pin.



Alignment fixtures are designed to accommodate customer products.

Technical Centers

Americas

SPIROL International Corporation
30 Rock Avenue
Danielson, Connecticut 06239 U.S.A.
Tel. +1 860 774 8571
Fax. +1 860 774 2048

SPIROL Shim Division
321 Remington Road
Stow, Ohio 44224 U.S.A.
Tel. +1 330 920 3655
Fax. +1 330 920 3659

SPIROL Canada
3103 St. Etienne Boulevard
Windsor, Ontario N8W 5B1 Canada
Tel. +1 519 974 3334
Fax. +1 519 974 6550

SPIROL Mexico
Avenida Avante #250
Parque Industrial Avante Apodaca
Apodaca, N.L. 66607 Mexico
Tel. +52 81 8385 4390
Fax. +52 81 8385 4391

SPIROL Brazil
Rua Mafalda Barnabé Soliane, 134
Comercial Vitória Martini, Distrito Industrial
CEP 13347-610, Indaiatuba, SP, Brazil
Tel. +55 19 3936 2701
Fax. +55 19 3936 7121

Europe

SPIROL France
Cit  de l'Automobile ZAC Croix Blandin
18 Rue L na Bernstein
51100 Reims, France
Tel. +33 3 26 36 31 42
Fax. +33 3 26 09 19 76

SPIROL United Kingdom
17 Princewood Road
Corby, Northants
NN17 4ET United Kingdom
Tel. +44 1536 444800
Fax. +44 1536 203415

SPIROL Germany
Ottostr. 4
80333 Munich, Germany
Tel. +49 89 4 111 905 71
Fax. +49 89 4 111 905 72

SPIROL Spain
08940 Cornell  de Llobregat
Barcelona, Spain
Tel. +34 93 669 31 78
Fax. +34 93 193 25 43

SPIROL Czech Republic
Prask 1847
274 01 Slan y
Czech Republic
Tel. +420 313 562 283

SPIROL Poland
Aleja 3 Maja 12
00-391 Warszawa, Poland
Tel. +48 510 039 345

Asia Pacific

SPIROL Asia Headquarters
1st Floor, Building 22, Plot D9, District D
No. 122 HeDan Road
Wai Gao Qiao Free Trade Zone
Shanghai, China 200131
Tel. +86 21 5046 1451
Fax. +86 21 5046 1540

SPIROL Korea
160-5 Seokchon-Dong
Songpa-gu, Seoul, 138-844, Korea
Tel. +86 (0) 21 5046-1451
Fax. +86 (0) 21 5046-1540

e-mail: info@spirol.com

SPIROL.com