

# CAS/PAM

## CASSETTE

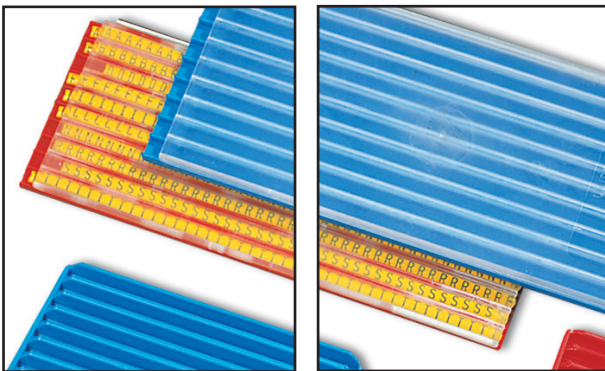

### CAS

#### Design

The cassette comprises of two identical lids, linked by a hinge on one side. The outer sides of the lids have grooves for storing PA marker strips. The lids of the two different designs fit one another and can thus be combined. The PAD installation tool can be stored inside the cassette (see separate product information). The cassette is supplied without markers.

#### Material

Polystyrene.

#### Colour

Red for PA02 and blue for PA1.

#### Temperature range

From -30°C to +60°C.

- Cassette for PA02- and PA1 sleeves.
- Flexible aid for service and maintenance marking.
- Pocket-size – easy to take along.
- Easy to refill from Partex standard range.
- CAS is double-sided for right and left mounting.
- PAM has transparent upper side which simultaneously protects the sleeve.

### PAM

#### Design

The cassette has 10 grooves for storing PA-marking strips and a transparent protective lid which is welded in place. One of the long sides has external holders for the PAV installation tool (see separate product information). The cassette is supplied without markers.

#### Material

ABS.

#### Colour

Red for PA02 and blue for PA1.

#### Temperature range

From -30°C to +60°C.

## DIMENSIONS IN MM (NOMINAL)

Article number	Colour	Number of grooves	Max. number of sleeves	Dimensioner i mm BxLxH	Innehåll
CAS-600EP	RED	12 X 2	300 X 2	67 X 90 X 21	PAD-3M
CAS-600E	RED	12 X 2	300 X 2	67 X 90 X 21	-
CAS-600MP	RED	12 X 2	300 X 2	67 X 90 X 21	PAD-3M
CAS-500EP	BLUE	10 X 2	250 X 2	67 X 90 X 21	PAD-5M
CAS-500E	BLUE	10 X 2	250 X 2	67 X 90 X 21	-
CAS-500MP	BLUE	10 X 2	250 X 2	68 X 90 X 21	PAD-5M
PAM-02EP	RED	10	10 X 44	61,5 X 150 X 7,5	PAV-02M
PAM-02E	RED	10	10 X 44	61,5 X 150 X 7,5	-
PAM-10EP	BLUE	10	10 X 44	72 X 152,5 X 8,5	PAV-1 0M
PAM-10E	BLUE	10	10 X 44	72 X 152,5 X 8,5	-

E = Empty; without installation tool pad and without sleeves.  
 EP = With tool and without sleeves.  
 MP = Filled; with tool and with sleeves, please contact Partex  
 M = Metal

## SIZES AND PACKAGING

Article number	Number/pck	Article number for refills
CAS-600E/EP/MP	1 pce	PA-02003PV×&.#
CAS-500E/EP/MP	1 pce	PA-10003PV×&.#
PAM-02E/EP	1 pce	PA-02003BV×&.#
PAM-10E/EP	1 pce	PA-10003BV×&.#

× = Sleeve colour, &= Print colour, # = Printed character

## APPLICATION

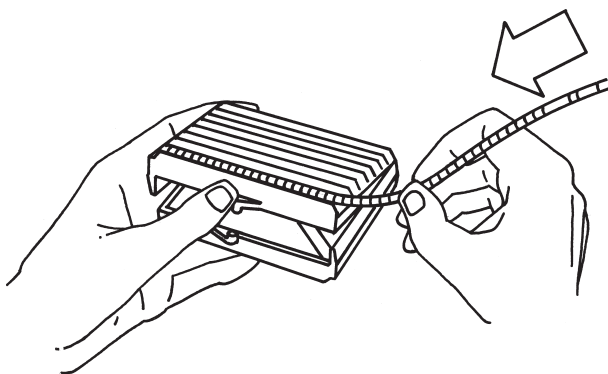

CAS

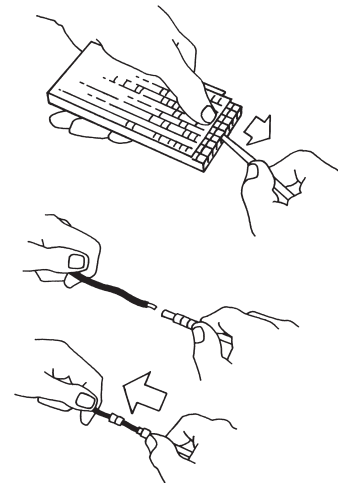

PAM